 **Subject Land**      **Address:** 23-29 Parker Street, TEMPLESTOWE LOWER 3107

Whilst all care has been taken in the preparation of this cadastral base map, Manningham and the State of Victoria accepts no responsibility for the accuracy of any information shown. Users should rely on their own enquiries in order to validate information shown on this map. This information is for Demonstration only.

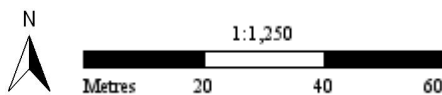

08/05/2019 9:36 am

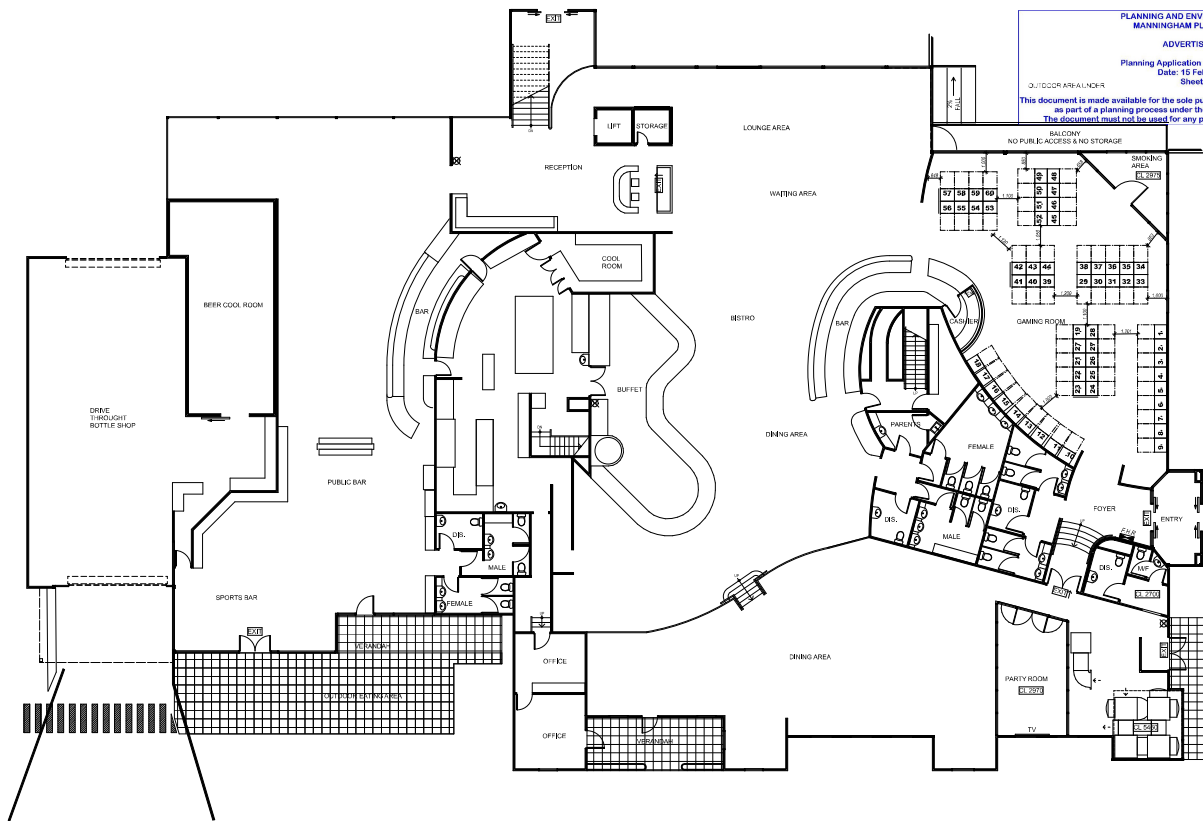

PLANNING AND ENVIRONMENT ACT 1987  
 MANNINGHAM PLANNING SCHEME  
 ADVERTISED PLANS  
 Planning Application Number: PLN18/0635  
 Date: 15 February 2019  
 Sheet 1 of 1  
 This document is made available for the sole purpose of enabling its consideration and review, as part of a planning process under the Planning and Environment Act 1987. This document must not be used for any purpose which may breach any Copyright.

PROPOSED GAMING PLAN  
 SCALE: 1:100

PARKER STREET



Enth Design Architects Pty Ltd  
 124/126 Sturt Rd, Sturt, SA 5102  
 Tel: (08) 9534 2188  
 Fax: (08) 9534 2187  
 © Enth Design Architects 2017

No.	Revision	Date	No.	Revised	Drawn



Project:  
**TEMPLESTOWE HOTEL**  
**23-29 PARKER STREET**  
**LOWER TEMPLESTOWE 3107**

Drawing:  
**PROPOSED GAMING PLAN**

Project Status:  
 Scale:  
 Date: Jan 2017  
 Drawn: DK  
 Checked:

Drawing No.:  
**GC02**  
 Job No.:  
**1408**  
 Section No.:

PL07 DATE: 2/05/2017